

Krypton Resources Sdn Bhd
 455, Taman Ming Hoe,
 Jalan Tuanku Antah,
 20100 Seremban,
 Negeri Sembilan Darul Khusus.
 Tel: 06-763 9993; Fax: 06-764 2103
 E-mail: krypton.res@gmail.com

Kleen Colour Coded Mopping Equipment

Modern cleaning systems that demand the highest hygiene standards require that cleaning equipment used for cleaning different areas be segregated. The best means of segregating cleaning equipment is by colour coding. But this in turn creates a problem of having several sets of the same equipment with different colours.

Kleen has come to the rescue with our **Kleen Colour Coded Mopping Equipment**. Some advantages of using Kleen Colour Coded include: improve training and communication, prevent cross-contamination, and enhance building safety. The results are improved performance, better sanitation and cleaner facilities.

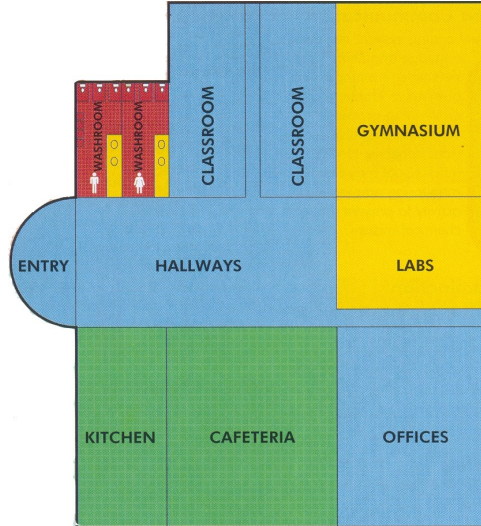

Adoption of the **Kleen Colour -Coded Mopping Equipment** would eliminate the problem of having multiple sets of the same equipment with different colours.



Kleen Colour-Coded achieves its distinct colour-coding through interchangeable features and durable decals. This gives flexibility to easily retask tools for different areas or functions as required. Unlike other systems, **Kleen** does not force you to buy new equipment every time you need to change colour coding or transfer tools to new areas.



Kleen Colour-Coded recommends :

- Red** for **Sanitary Washroom** : for areas of the washroom that have higher bacteria concentrations and specialized cleaning solutions, where sanitation is a priority. Particularly toilets and urinals
- Yellow** for **Speciality Cleaning** :for sinks and general washroom cleaning, to prevent cross contamination from toilet and urinal areas. May also be used for specialty cleaning activities such as gymnasiums, laboratories and floor care projects.
- Blue** for **General/User Specific**: for general cleaning in offices, hallways and reception areas. Or, task a set of tools for specialized areas of your building, such as hotel rooms, class rooms, manufacturing areas or medical facilities.
- Green** for **Food Service Areas**: for areas that come into contact with food, including kitchens, cafeterias and employee break rooms. Or use a separate colour for food preparation areas for added degree of safety.



Kleen Colour-Coded Mopping Equipment is made from high quality impact resistant plastic that can provide years of trouble free service. **Handy Lift** on the bottom of the bucket is a feature that aids in emptying the bucket of waste water. **Sturdy Wheels** that flares out to enhance stability and mobility. The wheels is of **All Plastic** material for rust and stain free performance. The **Mop Wringer** is also made from best materials to ensure durability and reliability. The wringer lever is constructed with a unique shape to offer maximum wringing efficiency. The pressure bars of the wringer is made from special impact proof plastic for maximum durability.